



# DYNA-KING®

*World's finest Hand Crafted Fly-Tying Vises and Accessories*

## INSTRUCTIONS FOR CHANGING JAWS

Simply remove the **Forcing Cone** by lifting up (pressing down if you have a rotary vise) on the **Cam Handle** and then unscrew the **Forcing Cone**. The **Jaw** will pull straight out, so you may replace it with a new set. At this point you may want to wipe the inside of the **Forcing Cone** with a cloth then re-lube with a light grease. We recommend a marine boat grease or even petroleum jelly will do fine. Then screw your **Forcing Cone** back on and you'll be ready to tie!

**IT IS IMPORTANT TO NEVER ADJUST THE FORCING CONE WHILE THE JAWS ARE CLOSED. THIS MAY CAUSE YOUR JAWS TO LOCK CLOSED & WILL CAUSE UNNECESSARY WEAR ON YOUR FORCING CONE & CAM HANDLE.**

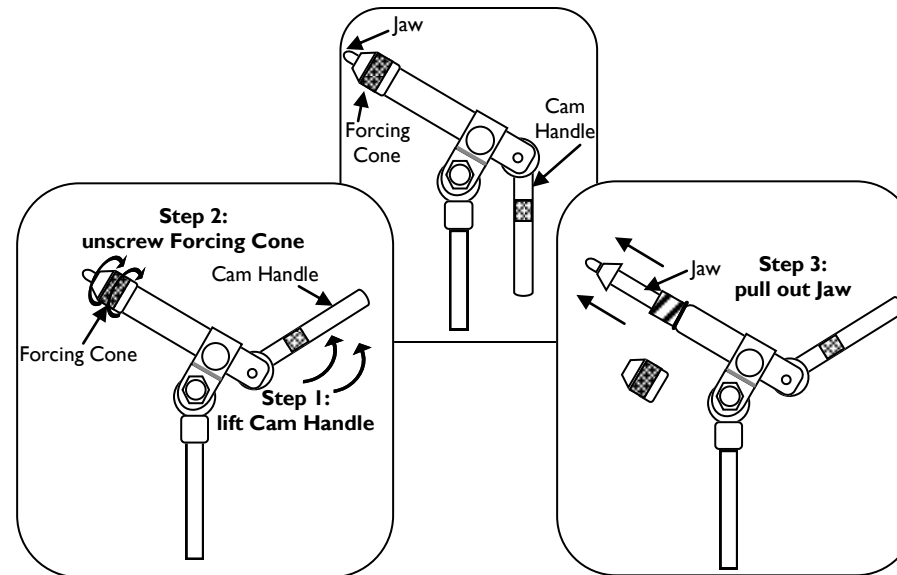

597 SANTANA DRIVE, UNIT A • CLOVERDALE, CA 95425, USA  
TOLL FREE (800) 396-2546 • PH (707) 894-5566 • FAX (707) 894-5566  
WWW.DYNA-KING.COM • EMAIL: INFO@DYNA-KING.COM